

CITY OF KENNEWICK—SIGHTLINE SETBACKS



MINOR/MAJOR STREET

DISTANCE CHART*	
SPEED LIMIT (MAJOR STREET)	DISTANCE FROM CENTER OF MAJOR STREET
50 MPH	525 FEET
45 MPH	470 FEET
40 MPH	415 FEET
35 MPH	360 FEET
30 MPH	310 FEET
25 MPH	250 FEET

* THE TRAFFIC ENGINEER SHALL DETERMINE THE SPEED LIMIT TO BE USED.

-SIGHT LINE AREA
NO OBSTRUCTIONS OVER 30-INCHES IN HEIGHT.
(FENCE, LANDSCAPING, ETC.)

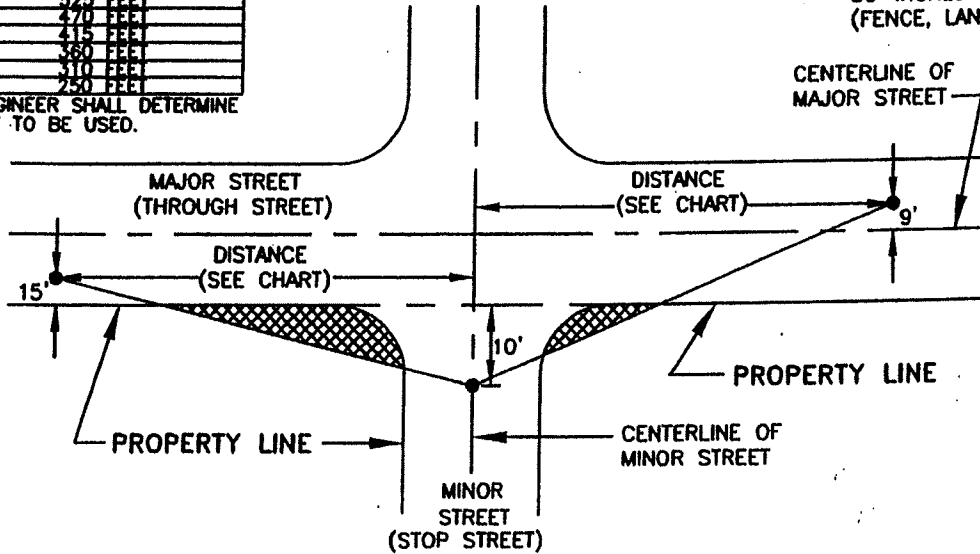

YIELD AND UNCONTROLLED T-INTERSECTIONS

-SIGHT LINE AREA
NO OBSTRUCTIONS OVER 30-INCHES IN HEIGHT.
(FENCE, LANDSCAPING, ETC.)

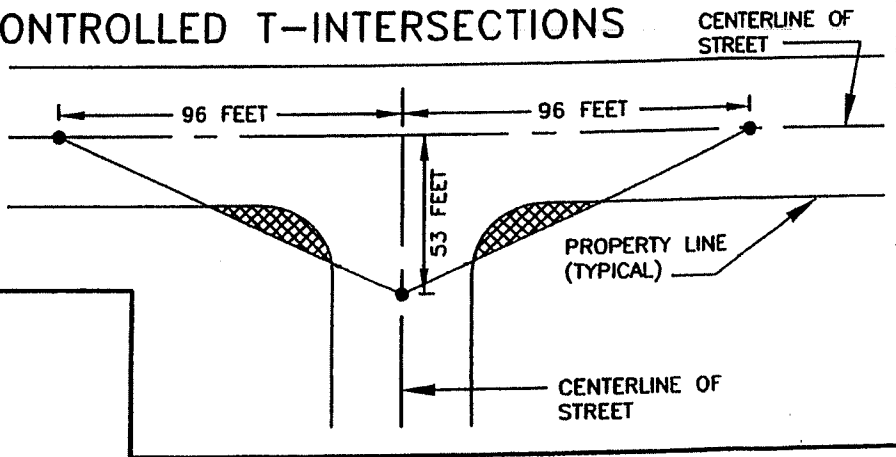

UNCONTROLLED CROSSING INTERSECTION

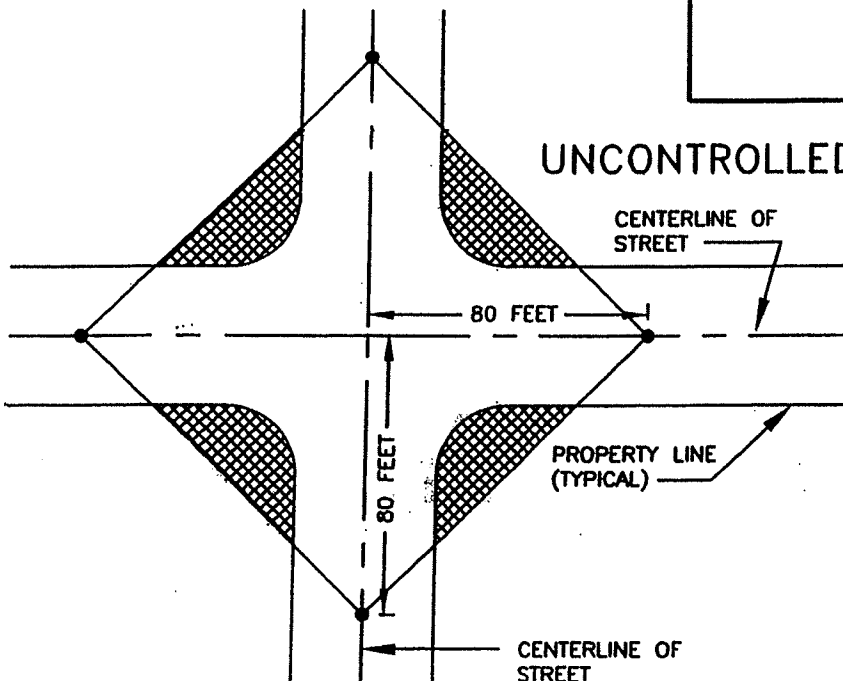

-SIGHT LINE AREA
NO OBSTRUCTIONS OVER 30-INCHES IN HEIGHT.
(FENCE, LANDSCAPING, ETC.)

CITY OF KENNEWICK RESIDENTIAL FENCING REQUIREMENTS

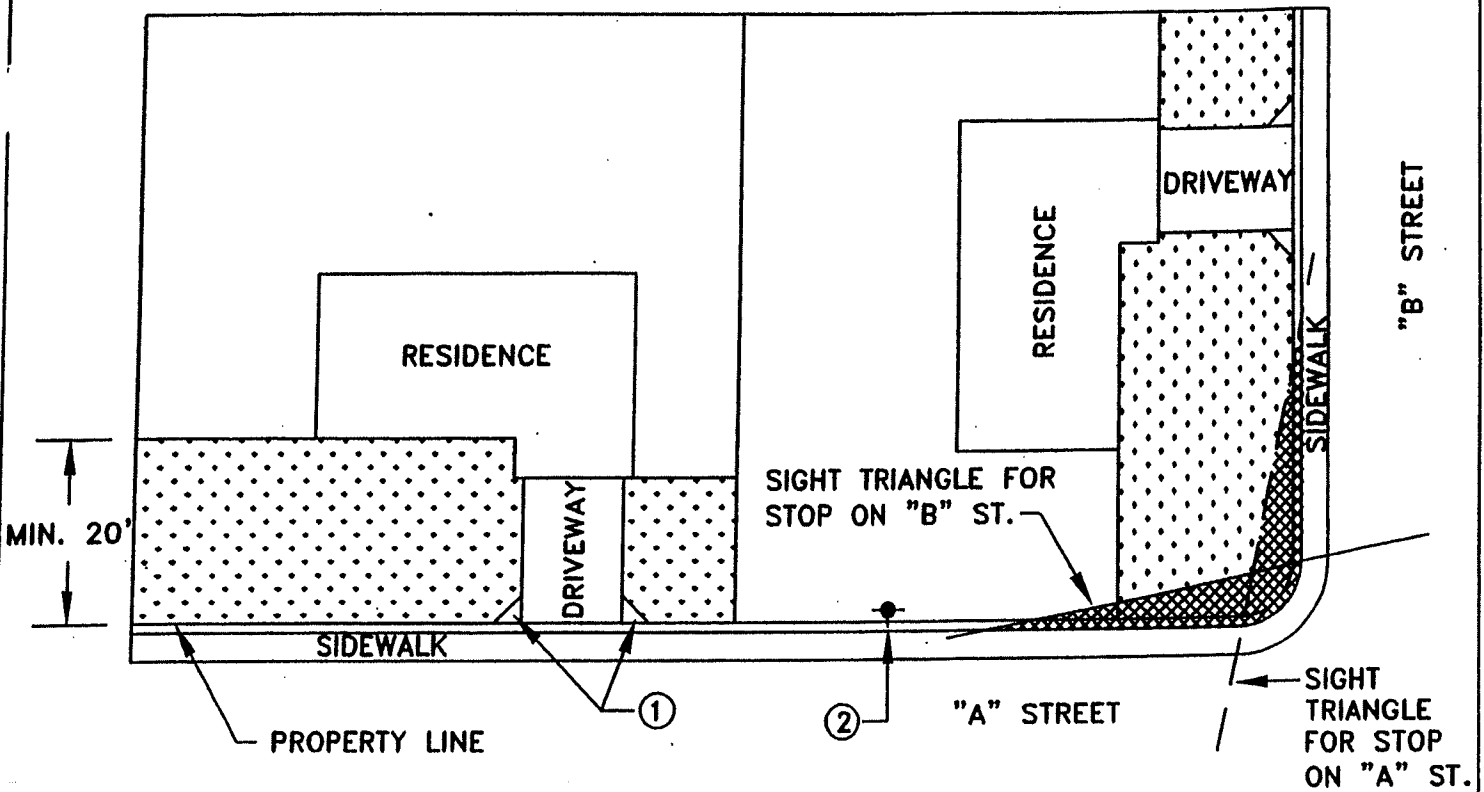

① DRIVEWAY SIGHT TRIANGLE- 5 FEET X 5 FEET

② FIRE HYDRANT CLEARANCE- 3 FEET ON ALL SIDES

▨ STREET SIGHT TRIANGLE- MAXIMUM 30-INCH HEIGHT LIMIT AREA (INCLUDES SHRUBS, FENCE, WALL, BERMS, ETC.) SEE DIAGRAM ON REVERSE SIDE FOR INTERSECTION SIGHT DISTANCES

▤ PATTERN SHOWS THE 36-INCH MAXIMUM HEIGHT LIMIT AREA (A MINIMUM 20' OFF FRONT PROPERTY LINE). THE REST OF THE YARD/LOT HAS AN 8 FOOT MAXIMUM HEIGHT LIMIT.

18.66.040: Fence Standards:

- (1) All fences must conform to the provisions of Title 15 and 13.12.
- (2) All fences in excess of 36 inches in height must be constructed with steel posts or with pressure-treated wood posts. Wooden posts must be set in gravel and compacted by earth. Steel posts must be set in concrete. Fences must be adequate to withstand a minimum windload of 70 miles per hour.
- (3) All fences in residential zones except Residential, Suburban shall be constructed of material commonly used in residential fence construction, such as chain link, wood slat, masonry walls, ornamental iron, wood pickets, and similar material. Fences of synthetic materials that have the functional equivalence of natural or traditional material may be substituted. The Director may adopt rules and regulations to implement this subsection.
- (4) Fences in Agricultural and Residential Suburban districts shall comply with provisions of this section. Fences for the containment of animals or the protection of crops, made from wood, barbed wire, and electric wire are permitted. The Director may adopt rules and regulations to implement this subsection.
- (5) Nothing in this section is intended to prohibit or restrict fences appropriate for a permitted use within any district, such as fences for protecting swimming pools, confining animals, protecting agricultural crops and the like. (Ord. 3838 Sec. 21, 1999; Ord. 3739 Sec. 1, 1997; Ord. 3099 Sec. 1 (part), 1987; Ord. 3001 Sec. 24 (part), 1986; Ord. 1594 Sec. 25.3 (4), 1972)
- (6) Property owner is responsible for requesting a final inspection.

SIGHTLINE SETBACK
Commercial Driveways

